

easicook.co.uk

Spare Parts Manual

Leading UK Distributors
of Catering Equipment Since 1977

Sales - Repairs - Spares

Tel: 029 20747567

Fax: 029 20214100

Email: info@easicook.co.uk

[Click Here for Live Online Chat](#)

Spare parts suitable for:
FAGOR

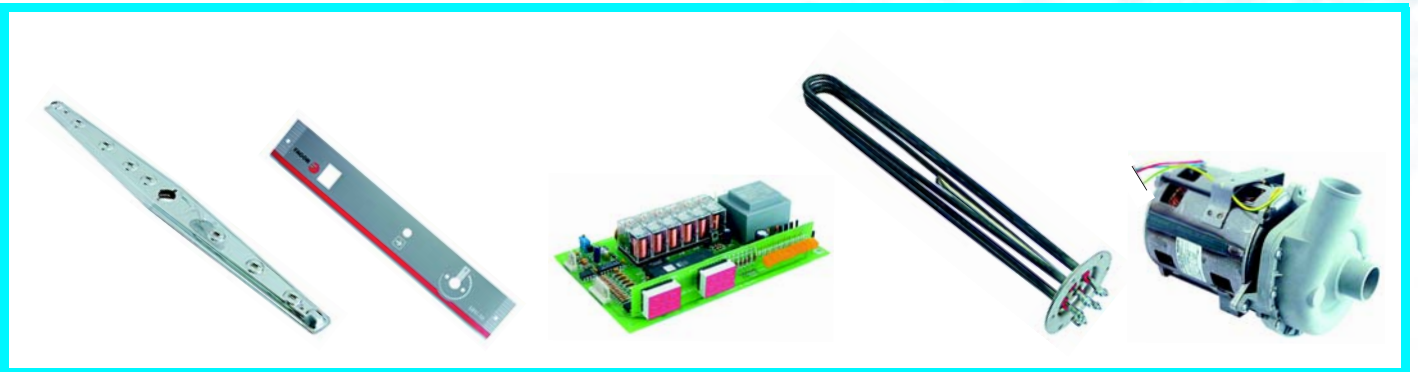



Wash and rinse systems

Page 4



Various and air traps

Page 6



Drain and filter systems

Page 7



Door and hood components

Page 8



Electrical components

Page 8



Dosing pumps

Page 11



Heating elements and boilers

Page 12



Pumps and components

Page 12

F Wash and rinse systems

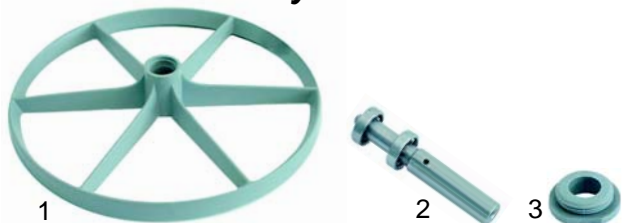

Item	Order	Description	Model	OEM
1	505170	basket turn table	LVR10, LVR14,	Z405901
2	505015	basket turn table bearing, compl.	LVR14D, LVR20, LVR20B, LVR20D	Z405903
3	505016	cap		Z605906



Item	Order	Description	Model	OEM
1	505017	basket turn table switch		Z400701
2	505167	gasket	LVR10, LVR14,	Z400703
3	505020	opposite support	LVR14D, LVR20, LVR20B, LVR20D	Z400702
4	505033	wash jet		Z400709
5	505031	wash jet clip		Z400711



Item	Order	Description	Model	OEM
1	505089	rinse arm holder	LVR10, LVR14, LVR14D, LVR20, LVR20B, LVR20D	Z401913
2	505067	rinse arm	LVR10, LVR14, LVR14D	Z401915
3	505090	rinse arm	LVR20, LVR20B, LVR14D	Z421904
4	505044	rinse jet	LVR10, LVR14,	Z201905
5	505045	gasket	LVR14D, LVR20, LVR20B, LVR20D	Q307036
6	505046	rinse jet clip		Z201906



Item	Order	Description	Model	OEM
1	505068	wash arm cross		Z410704
2	505036	wash arm A		Z460702
3	505054	wash arm B	LVC12, LVC15, LVC15D	Z460701
4	505042	rinse arm A		Z461902
5	505063	rinse arm B		Z4610901

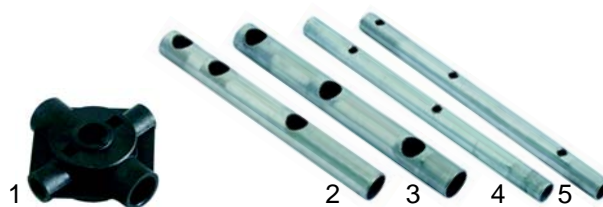

Item	Order	Description	Model	OEM
1	505068	wash arm cross		Z410704
2	505037	wash arm A	LVC21, LVC21B, LVC21D	Z440706
3	505055	wash arm B		Z440707
4	505043	rinse arm A		Z441901
5	505064	rinse arm B		Z441902



Item	Order	Description	Model	OEM
1	505033	wash jet		Z400709
2	505031	wash jet clip	LVC12, LVC15, LVC15D, LVC21, LVC21B, LVC21D	Z400711
3	505044	rinse jet		Z201905
4	505045	O-ring		Q307036
5	505046	rinse jet clip		Z201906
6	505103	rinse jet (s/s)		Z211903

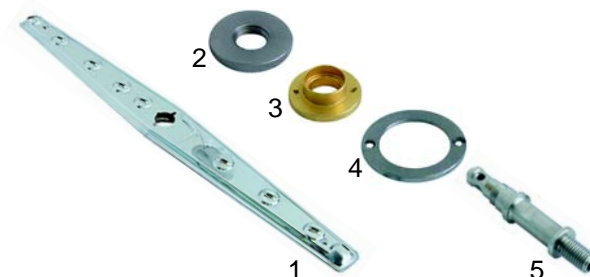

Item	Order	Description	Model	OEM
1	505038	wash arm		Z650716
2	505171	lock nut	FI30, FI48, FI48B, FI50, FI64, FI64B, FI72, FI82	Z200705
3	505040	wash arm bearing		Z650704
4	505172	disc		Z650711
5	505048	wash arm shaft		Z200704

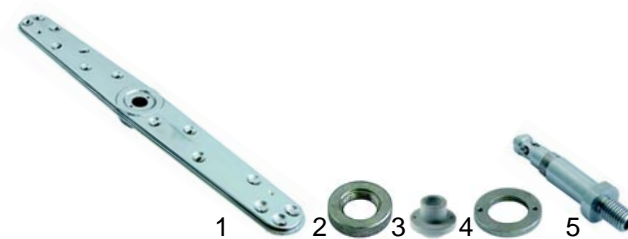

Item	Order	Description	Model	OEM
1	505039	wash arm		Z710701
2	505173	lock nut		Z680738
3	505041	wash arm bearing	FI100, FI120, ECO120	Z710712
4	505174	disc		Z710713
5	505049	wash arm shaft		Z710711

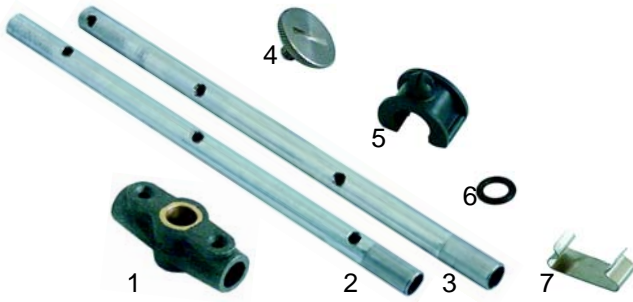

Item	Order	Description	Model	OEM
1	505069	rinse arm boss		Z201903
2	505062	rinse arm, left		Z201902
3	505061	rinse arm, right	FI30, FI48, FI48B,	Z201901
4	505034	lock screw	FI50, FI64, FI64B,	Q152016
5	505044	rinse jet	FI72, FI82, FI100,	Z201905
6	505045	gasket	FI120, ECO120	Q307036
7	505046	rinse jet clip		Z201906

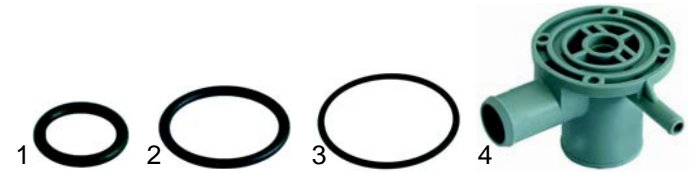

Item	Order	Description	Model	OEM
1	505177	O-ring (pin)		Q307050
2	505175	O-ring, inner	FI30, FI48, FI48B,	Q307052
3	505178	O-ring, outer	FI50, FI64, FI64B,	Q307049
4	505051	support	FI72	Z200703



Item	Order	Description	Model	OEM
1	505059	wash arm support, upper	FI80	Z740703
2	505019	wash arm column, lower		Z740702

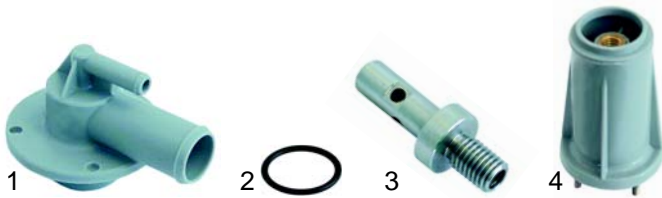

Item	Order	Description	Model	OEM
1	505056	wash arm support, upper		Z410703
2	505175	O-ring	LVC12, LVC15,	Q307052
3	505047	wash arm shaft	LVC15D, LVC21,	Z410708
4	505050	wash arm support, lower	LVC21B,	Z410701



Item	Order	Description	Model	OEM
1	505060	wash arm support, upper	FI100, FI120,	Z710705
2	505022	wash arm column, lower	ECO120	Z710704



Item	Order	Description	Model	OEM
1	505167	gasket		Z400703
2	505176	O-ring	LVC12, LVC15,	Q307056
3	505052	extension	LVC15D, LVC21,	Z410712
4	505053	support, lower	LVC21B,	Z410702

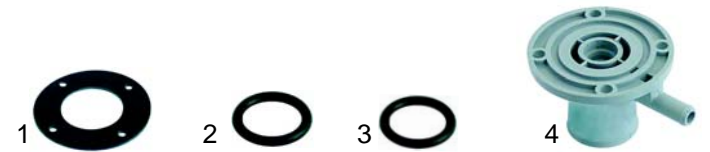

Item	Order	Description	Model	OEM
1	505179	gasket		Z710714
2	505180	O-ring	FI80, FI100, FI120,	Q307057
3	505177	O-ring (pin)	ECO120	Q307050
4	505021	support		Z710706

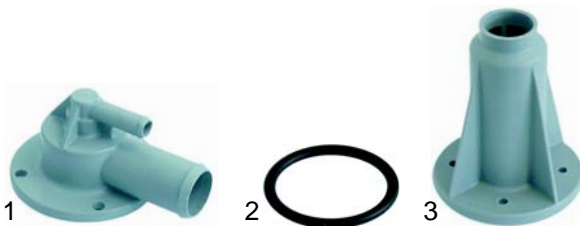

Item	Order	Description	Model	OEM
1	505057	wash arm support, upper	FI30, FI48,	Z200707
2	505175	O-ring	FI48B, FI50,	Q307052
3	505018	wash arm column, lower	FI64, FI64B,	Z200701
			FI72	

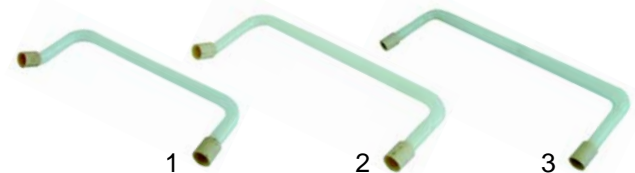

Item	Order	Description	Model	OEM
1	505181	rising pipe	LVC12, LVC15, LVC15D	Z410711
2	505182	rising pipe	LVC21, LVC21B,	Z440711
			LVC21D	
3	505211	rising pipe	FI30, FI48, FI48B, FI50,	Z200706
			FI64, FI64B	

Suitable for Fagor



Item	Order	Description	Model	OEM
1	505188	rising pipe	FI72	Z260701
2	505189	outlet hose/ rising pipe	FI80	Z740902

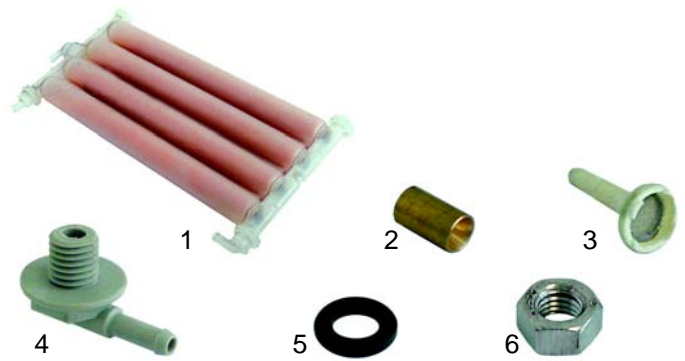

Item	Order	Description	Model	OEM
1	505102	softener	LVR14D, LVR20D, LVC15D, LVC21D	Z471101
2	505197	weight		Z701152
3	505198	filter		Z601153
4	505083	injector		Z230502
5	505199	gasket		Q307031
6	505200	nut		Q162070

Various



Item	Order	Description	Model	OEM
1	505087	spider body		Z401108
2	505088	Y-piece		Z201106
3	505086	T-fitting		Z601157



Item	Order	Description	Model	OEM
1	505085	collector/ drain pump	LVR20B, LVC21B	Z430901
2	505104	collector/ drain pump	FI64B	Z220902



Item	Order	Description	Model	OEM
1	505091	back flow restrictor		Z231105

Air traps



Item	Order	Description	Model	OEM
1	505094	air trap		Z203011
2	505095	O-ring		Q307003
3	505096	connecting piece	LVR__, LVC__, FI__, ECO__	Z203012
4	505184	banjo bolt		Z203013
5	505146	air trap		Z763008

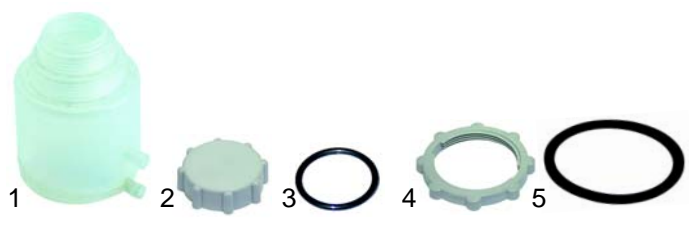

Item	Order	Description	Model	OEM
1	505101	salt container		Z471102
2	510015	cap	LVR14D, LVR20D, LVC15D, LVC21D	Z471108
3	510072	O-ring		Z471109
4	510018	nut		Z471106
5	510071	gasket		Z471107

Drain and filter systems

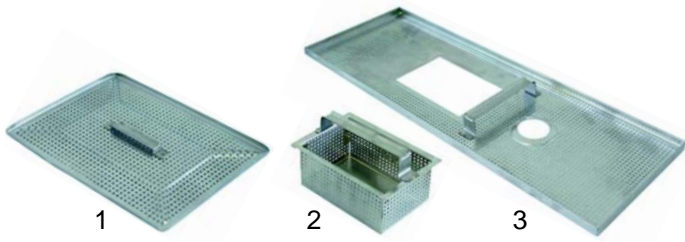

Item	Order	Description	Model	OEM
1	505185	flat filter	FI48, FI48B, FI50, FI64, FI64B, FI72	Z210801
2	505186	basket filter	FI80, FI100, FI120, ECO120	Z710804
3	505187	flat filter		Z710801



Item	Order	Description	Model	OEM
1	505078	basin gasket	FI30, FI48, FI48B,	Z200907
2	505080	basin clamp	FI50, FI64, FI64B,	Z200908
3	505191	drain hose clip	FI72	Q901308

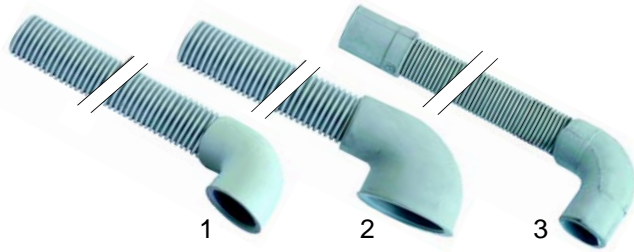

Item	Order	Description	Model	OEM
1	505081	drain hose	LVR__, LVC__, FI30	Z400908
2	505082	drain hose	FI48, FI50, FI64, FI72, FI80, FI100, FI120, ECO120	Z200910
3	505084	drain hose/ drain pump	LVR20B, LVC21B, FI64B	Z220903

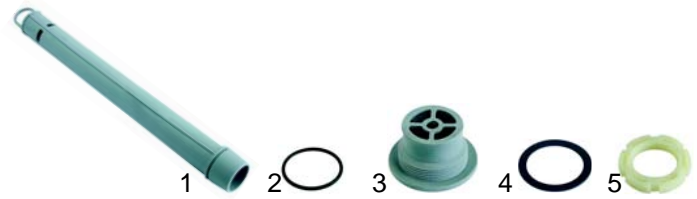

Item	Order	Description	Model	OEM
1	505072	drain plug		Z710901
2	505192	O-ring	FI80, FI80W,	Q307061
3	505193	drain seating	FI100, FI120, ECO120	Z710902
4	505194	gasket		Q307059
5	505155	nut		Q220001

Hoses

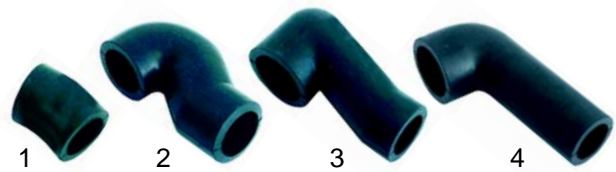

Item	Order	Description	Model	OEM
1	505026	inlet hose	LVR__, LVC__	Z400906
2	505023	outlet hose		Z400905
3	505024	inlet hose	FI30, FI48, FI48B,	Z200904
4	505028	outlet hose	FI50, FI64, FI64B, FI72	Z200905



Item	Order	Description	Model	OEM
1	505077	basin gasket	LVR10, LVR14, LVR14D, LVR20,	Z400902
2	505079	basin clamp	LVR20D, LVC12, LVC15, LVC15D,	Z400903
3	505190	drain hose clip	LVC21, LVC21B, LVC21D	Q901307



Item	Order	Description	Model	OEM
1	505025	inlet hose		Z710904
2	505027	outlet hose	FI80	Z740901
3	505032	outlet hose, lower		Z740903



Item	Order	Description	Model	OEM
1	505071	drain plug		Z200909
2	505074	O-ring	FI30, FI48, FI48B,	Q307051
3	505076	filter	FI50, FI64, FI64B, FI72	Z200901
4	505013	sump		Z200906



Item	Order	Description	Model	OEM
1	505025	inlet hose		Z710904
2	505030	outlet hose, upper	FI100, FI120, ECO120	Z710906
3	505029	outlet hose, lower		Z710905

Over flow pipes



Item	Order	Description	Model	OEM
1	505070	drain plug	LVR10, LVR14, LVR14D,	Z400907
2	505073	O-ring	LVR20, LVR20D, LVC12,	Q307041
3	505075	filter	LVC15, LVC15D, LVC21, LVC21B, LVC21D	Z400904
4	505012	sump		Z400901

Door and hood components



Item	Order	Description	Model	OEM
1	505006	hinge, right		Z400514
2	505005	hinge, left	LVR__	Z400515
3	505195	guide plate	LVC__, FI__	Z200310
4	505149	door buffer		Z200522



Item	Order	Description	Model	OEM
1	505007	door locking catch	LVR__, LVC__,	Z200607
2	505196	door catch	FI__	Z200601
3	505001	door handle	LVR__, LVC__	U580521
4	505002	door handle	FI__	Z200512, Z650531



Item	Order	Description	Model	OEM
1	505009	spring		Z710528
2	505008	spring compressor	FI80, FI100, FI120, ECO120	Z710529
3	505010	screw		Z710544

Electrical components

Frontfoils

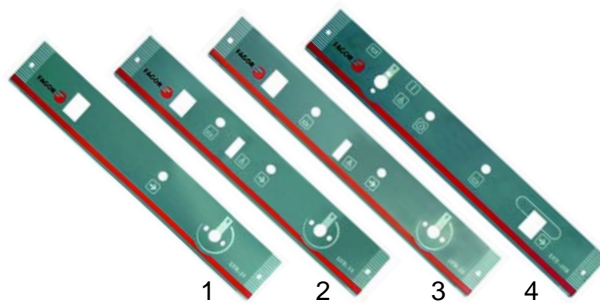

Item	Order	Description	Model	OEM
1	505105	fascia	LVR10	Z392901
2	505106	fascia	LVR14	Z402909
3	505107	fascia	LVR20	Z422909
4	505111	fascia	LVR20B	Z432906

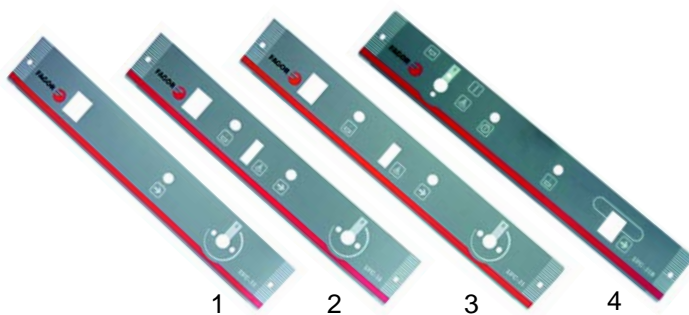

Item	Order	Description	Model	OEM
1	505108	fascia	LVC12	Z462901
2	505109	fascia	LVC15	Z412901
3	505110	fascia	LVC21	Z442901
4	505112	fascia	LVC21B	Z452901

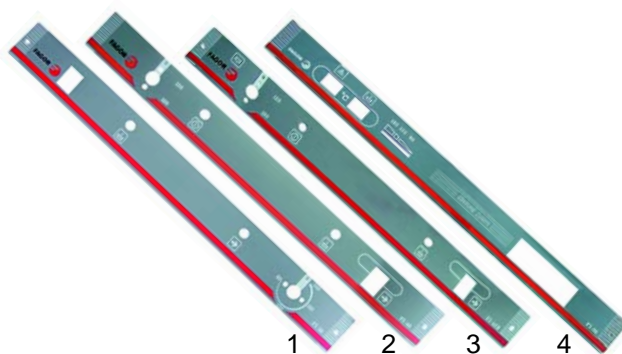

Item	Order	Description	Model	OEM
1	505117	fascia	FI30	Z202909
2	505119	fascia	FI48	Z212910
3	505120	fascia	FI48B	Z222902
4	505118	fascia	FI50	Z232901

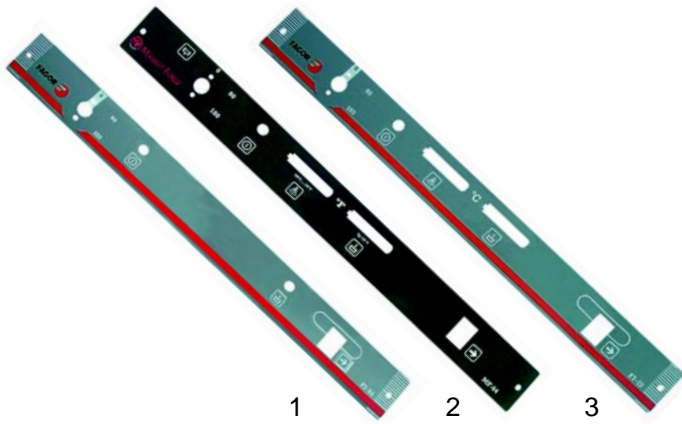

Item	Order	Description	Model	OEM
1	505121	fascia	FI64	Z242901
2	505122	fascia	FI64B	Z258501
3	505124	fascia	FI72	Z262906



Item	Order	Description	Model	OEM
1	505201	fascia	FI80 to '8.2000	Z742901
2	505126	fascia	FI80 ab '9.2000	Z742906
3	505202	fascia	FI100	Z712908

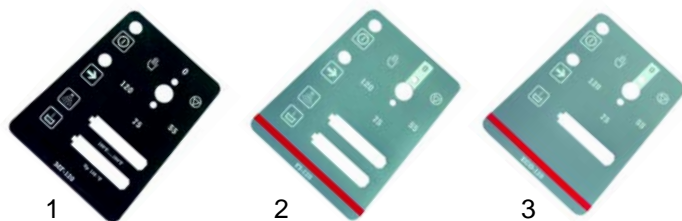

Item	Order	Description	Model	OEM
1	505203	fascia	FI120 to '8.2000	Z728501
2	505204	fascia	FI120 ab '9.2000	Z722901
3	505205	fascia	ECO120	Z732901

Switch



Item	Order	Description	Model	OEM
1	301002	main switch	LVR__, LVC__, FI__	Z203033
2	345489	rinse push button	LVR14, LVR20, LVC15, LVC21	Z403033
3	345491	start button	LVR20D, LVC21B, FI48__, FI64__, FI72	Z213001, Z213033

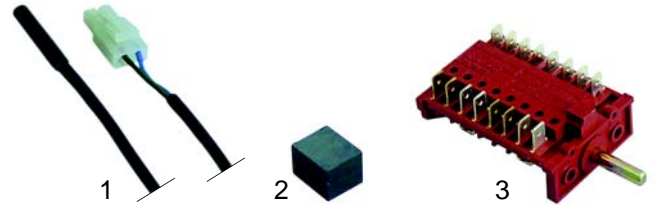

Item	Order	Description	Model	OEM
1	345146	magnetic switch	universal	Z203009
2	505004	magnet		Z200506
3	345494	program switch	LVR14D, LVR20B, LVR20D, LVC15D, LVC21B, LVC21D	Z433001

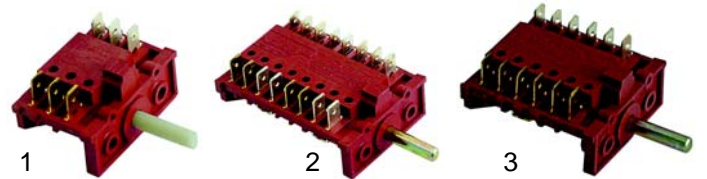

Item	Order	Description	Model	OEM
1	345492	program switch	FI48, FI64, FI72	Z213003
2	345493	program switch	FI48B, FI64B	Z223001
3	345496	program switch	FI80	Z273005



Item	Order	Description	Model	OEM
1	345495	program switch	FI100, FI120, ECO120	Z683085
2	113005	knob	universal	R663062
3	359027	signal lamp, green	universal	R693055
4	359048	signal lamp, yellow	universal	R693056

Solenoid valves

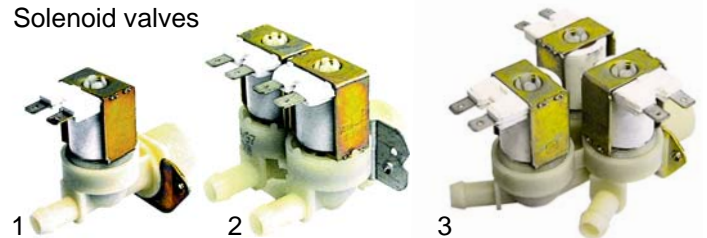

Item	Order	Description	Model	OEM
1	370017	single	LVR10, LVC12, FI48, FI48B, FI50, FI64, FI64B, FI72, FI80, FI100, FI120	Z701135
2	370021	double	LVR14, LVR20, LVR20B, LVC15, LVC21, LVC21B	P255001
3	370025	triple	LVR14D, LVR20D, LVC15D, LVC21D	Z611124

Timers

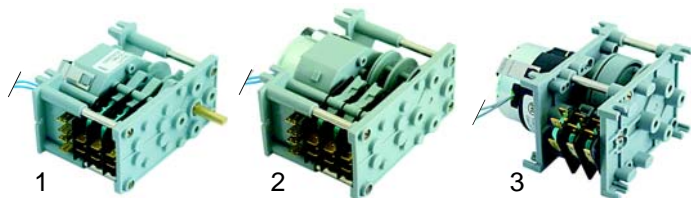

Item	Order	Description	Model	OEM
1	361352	timer, 120 sec	LVR10, LVR14, LVR14D, LVR20, LVR20D, LVC12, LVC15, LVC15D, LVC21, LVC21D	Z403002
2	361357	timer, 120 sec	LVR20B, LVC21B	Z433002
3	361350	regeneration, 20min.	LVR14D, LVR20D, LVC15D, LVC21D	Z613003



Item	Order	Description	Model	OEM
1	361351	timer, 240 sec	FI30, FI80 to '8.2000	Z203030
2	361354	timer, 90 sec/ 180 sec	FI48, FI48B	Z213008
3	361355	timer, 60 sec/ 180 sec	FI64, FI64B, FI72, FI80 ab '9.2000	Z268302, Z243004

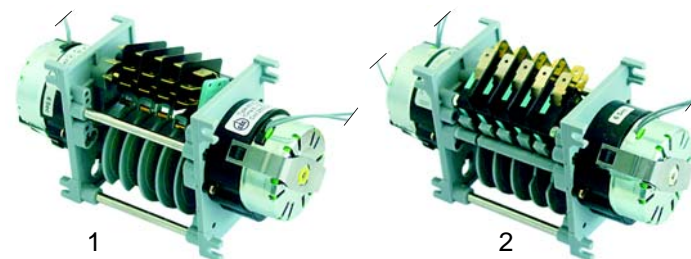

Item	Order	Description	Model	OEM
1	361353	timer, 240 sec	FI100 to '8.2000	Z683099
2	361358	timer, 90 sec/ 180 sec	FI120 to '8.2000	Z728302

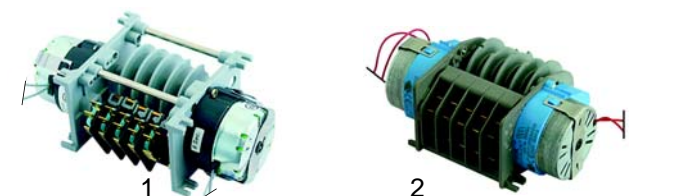

Item	Order	Description	Model	OEM
1	361356	timer, 240 sec	ECO120	Z703004
2	360271	timer, 90 sec/ 180 sec	FI100 ab '9.2000, FI120 ab '9.2000	Z713055

Pressure switches



Item	Order	Description	Model	OEM
1	541297	28/13	LVR__, LVC__, LVR__D, LVC__D	Z403021, Z103074
2	541296	28/13, 65/50	LVR__B, LVC__B	Z433003, Z433011



Item	Order	Description	Model	OEM
1	541302	40/15	FI30, FI48, FI48B, FI50, FI64, FI64B, FI72	Z203023
1	541299	95/75	FI48B, FI64B	Z223005
1	541298	170/75	FI80, FI100, FI120, ECO120	Z713002
2	541109	Y-connection	LVR__B, LVC__B, FI__B	Z103077

Relays, contactors

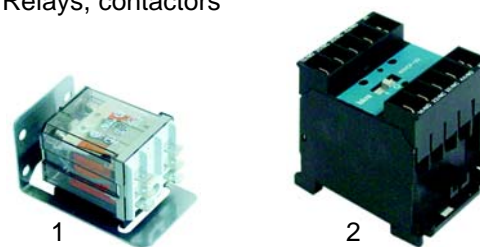

Item	Order	Description	Model	OEM
1	380610	relay, 16A, 2 NO	LVR10, LVR14, LVR20, LVR14D, LVR20D, LVC12, LVC15, LVC21, LVC15D, LVC21D, LVR20B, LVC21B, FI30, FI48, FI48B, FI50, FI64, FI64B,	Z230018
2	380416	contactor, 20A, 3 NO, 1 NC	LVR10 ab 9.2000, LVR14, LVR14D LVR20, LVR20B, LVR20D, LVC15, LVC15D, LVC21, LVC21B, LVC21D FI30, FI48, FI48B, FI50, FI64, FI64B, FI72, FI80, FI100, FI120, ECO120	Z213007
2	380415	contactor, 20A, 4 NO	FI80 ab '9.2000, FI100, FI120, ECO120	Z683087

Electrical

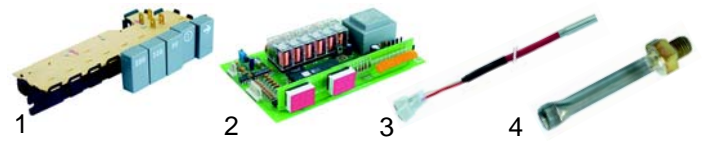

Item	Order	Description	Model	OEM
1	345490	keyboard		Z233006
2	400810	control p.c.b.	FI50	Z233005
3	379550	sensor		Z233007
4	505207	thermostat pocket		Z263002

Thermometers



Item	Order	Description	Model	OEM
1	541300	thermometer	FI72, FI100, FI120, ECO120	Z263001
2	505212	connector block		Z603025
3	505213	connector block		R253044

Dosing pumps

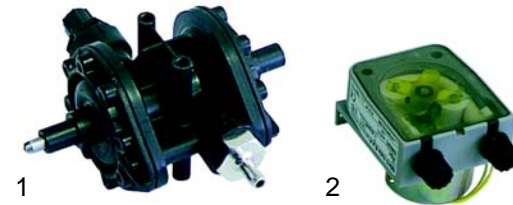

Item	Order	Description	Model	OEM
1	361221	rinse aid		Z651123
2	361152	detergent		Z230521



Item	Order	Description	Model	OEM
1	505197	weight		Z701152
2	505198	filter		Z601153
3	505083	tank inlet		Z230902
4	505199	gasket		Q307031
5	505200	nut		Q162070
6	505086	T-fitting		Z601157

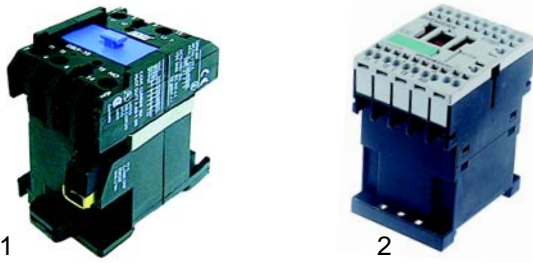

Item	Order	Description	Model	OEM
1	380204	contactor	FI30 ab '9.2000, FI48 ab '9.2000, FI48B ab '9.2000, FI64 ab '9.2000, FI64D	Z203050
2	380614	contactor	FI120	Z663031

Thermostats



Item	Order	Description	Model	OEM
1	390450	contact thermostat	LVR_, LVC_, FI30, FI48, FI48B, FI64, FI64B, FI72, FI80, FI100, FI120, ECO120	Z718405, Z653013
2	505093	gasket		N503017
3	390451	safety and contact thermostat, 115 °C	ab '9.2000 FI80, FI100, FI120, ECO120	R213004

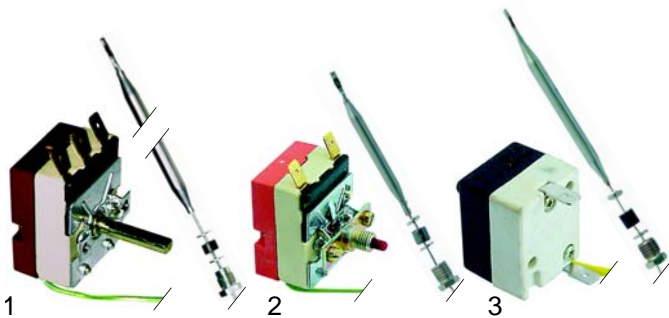

Item	Order	Description	Model	OEM
1	375400	thermostat	LVR_, LVC_, FI30, FI48, FI48B, FI64, FI64B, FI72, FI80, FI100, FI120	Z393005, Z203014
2	390453	safety thermostat, 130 °C	to '8.2000: FI48, FI48B, FI50, FI64, FI64B, FI72, FI100, FI120	R343124
3	390452	safety thermostat	ab '9.2000: FI48, FI48B, FI50, FI64, FI64B, FI72	Z213014

F Heating elements and boilers

Suitable for Fagor

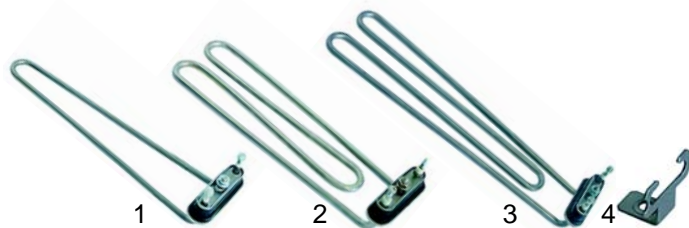

Item	Order	Description	Model	OEM
1	416380	1000W/230V	LVR10, LVC12, ECO120	Z733601
2	416381	2000W/230V	LVR14, LVR14D, LVR20, LVR20D, LVC15, LVC15D, LVC21, LVC21D, LVR20B, LVC21B	R223005
3	416382	2800W/230V	FI30, FI48, FI48B, FI50, FI64, FI64B, FI72, FI80, FI100, FI120	Z203601
4	505208	holder	universal	Z603602

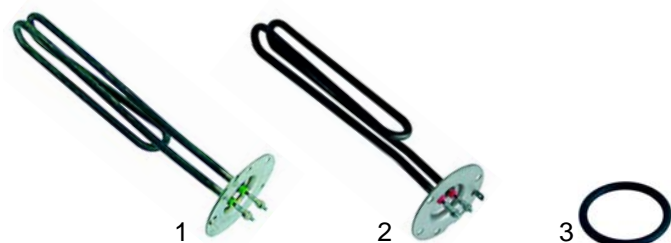

Item	Order	Description	Model	OEM
1	416383	2400W/230V	LVR10, LVR14, LVR14D, LVC12, LVC15, LVC15D	Z401711
2	416387	2800W/230V	LVR20, LVR20B, LVR20D, LVC21, LVC21B, LVC21D	Z421711
3	505092	gasket	LVR__, LVC__	Q307053



Item	Order	Description	Model	OEM
1	416384	2800W/230V	FI30, FI48, FI48B, FI10	Z201706
2	416385	6000W/230-400V	FI64, FI64B, FI72, FI80, FI100, FI120	Z241701
3	416386	9000W/230-400V	FI120	Z728306
4	691033	gasket	FI__	Q307035

Boilers

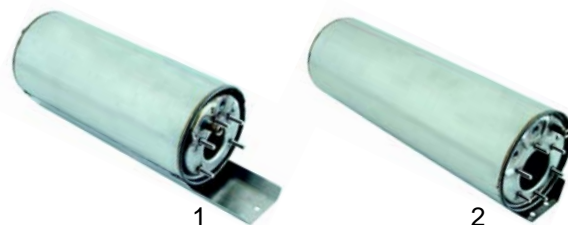

Item	Order	Description	Model	OEM
1	505209	boiler	LVR__, LVC ab '9.2000	Z401701, Z401730
2	505210	boiler	FI30, FI48, FI48B, FI50, FI64, FI64B, FI72, FI80, FI100, FI120	Z201701, Z201710

Pumps and components



Item	Order	Description	Model	OEM
1	500322	drain pump	LVR__B, LVC__B, FI__B	Z220901
2	500321	230W/230V	LVR__, LVC__	Z401001
3	500320	590W/230V	FI	Z201011

Pumps	Impellor	Mechanical seal	Capacitor	
500321	Z401001	-	-	365012 V817100
500320	Z201011	Z201082	Z201081	365015 V321300